

# Digital VET **EPFL**

Prof. Pierre Dillenbourg  
Associate Vice-President for Education



Schweizerische Eidgenossenschaft  
Confédération suisse  
Confederazione Svizzera  
Confederaziun svizra





<http://www.sudinfo.be/>



**1918**

**2018**



<http://www.parchmentlibrary.org/parchment-schools?lightbox=dataItem-irqykbi31>



<https://clesdelaclasses.fr/reforme-rythmes-scolaires-point/>

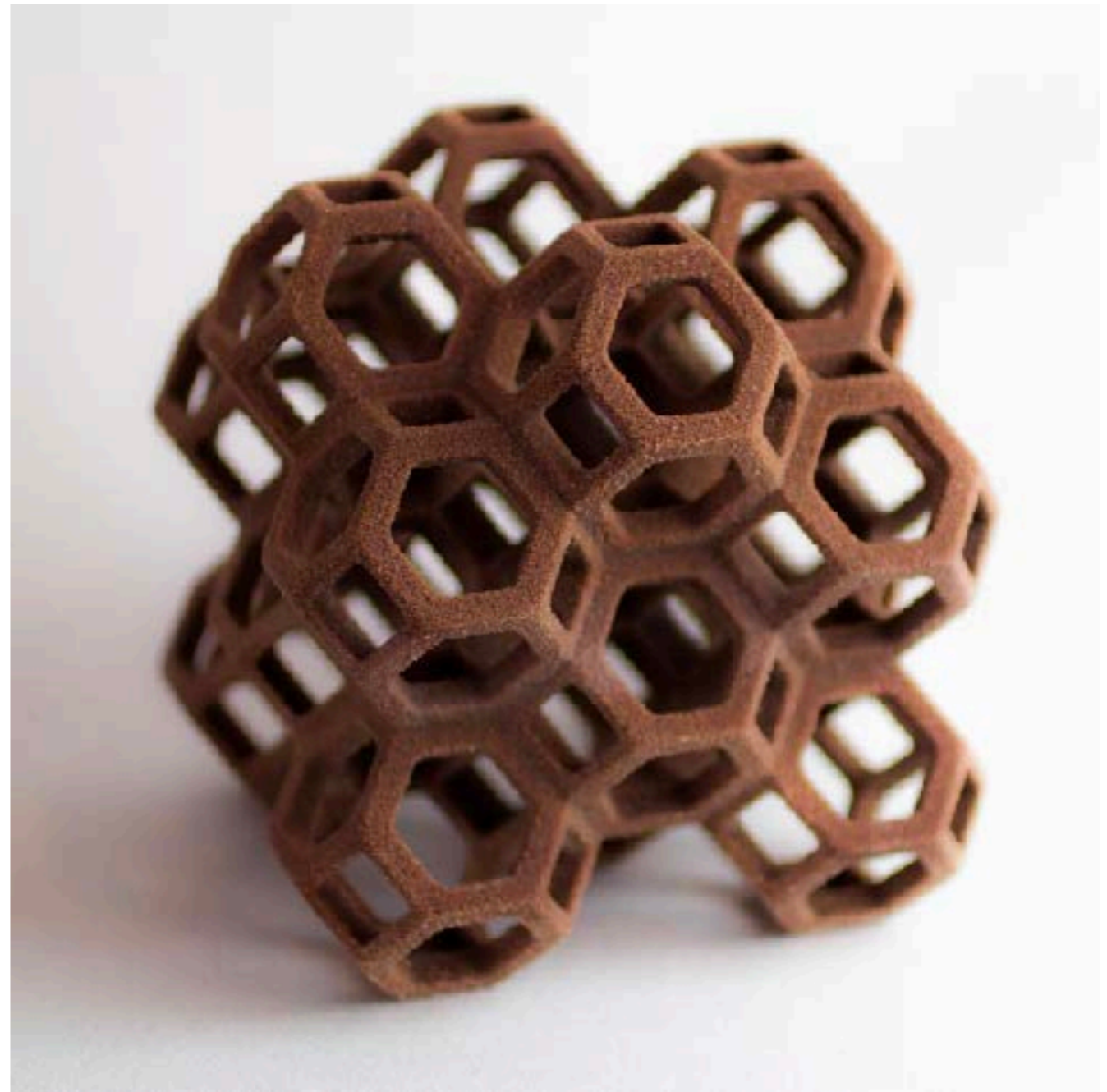



<https://www.neozone.org/imprimante-3d/impression-3d-en-3-ans-le-danois-cobod-devient-le-leader-mondial-de-la-construction-3d/>

System Governance

3

Proportion of MOOC students who dropped out by # of logged online interactions with the website.

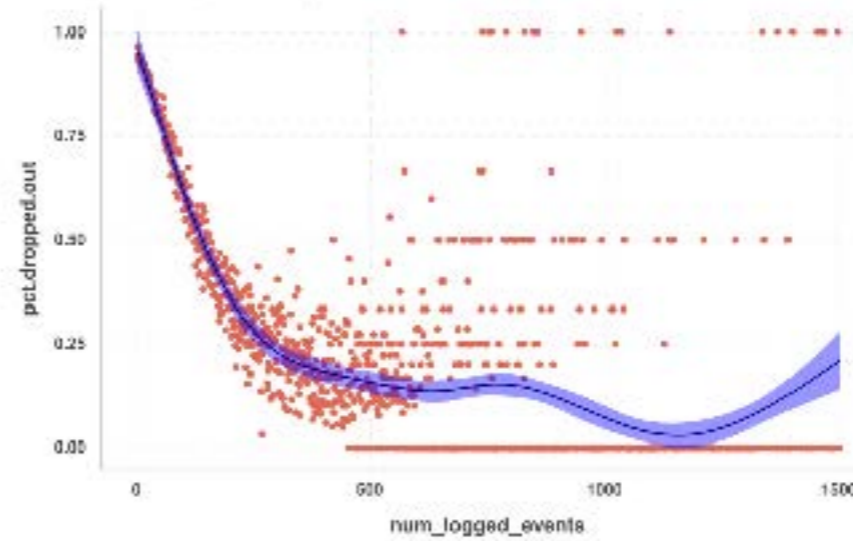

2

Pedagogical methods & tools



Goals & Contents

1



<https://www.ouest-france.fr/le-boulangier-philosophe-nous-raconte-le-pain-56936>

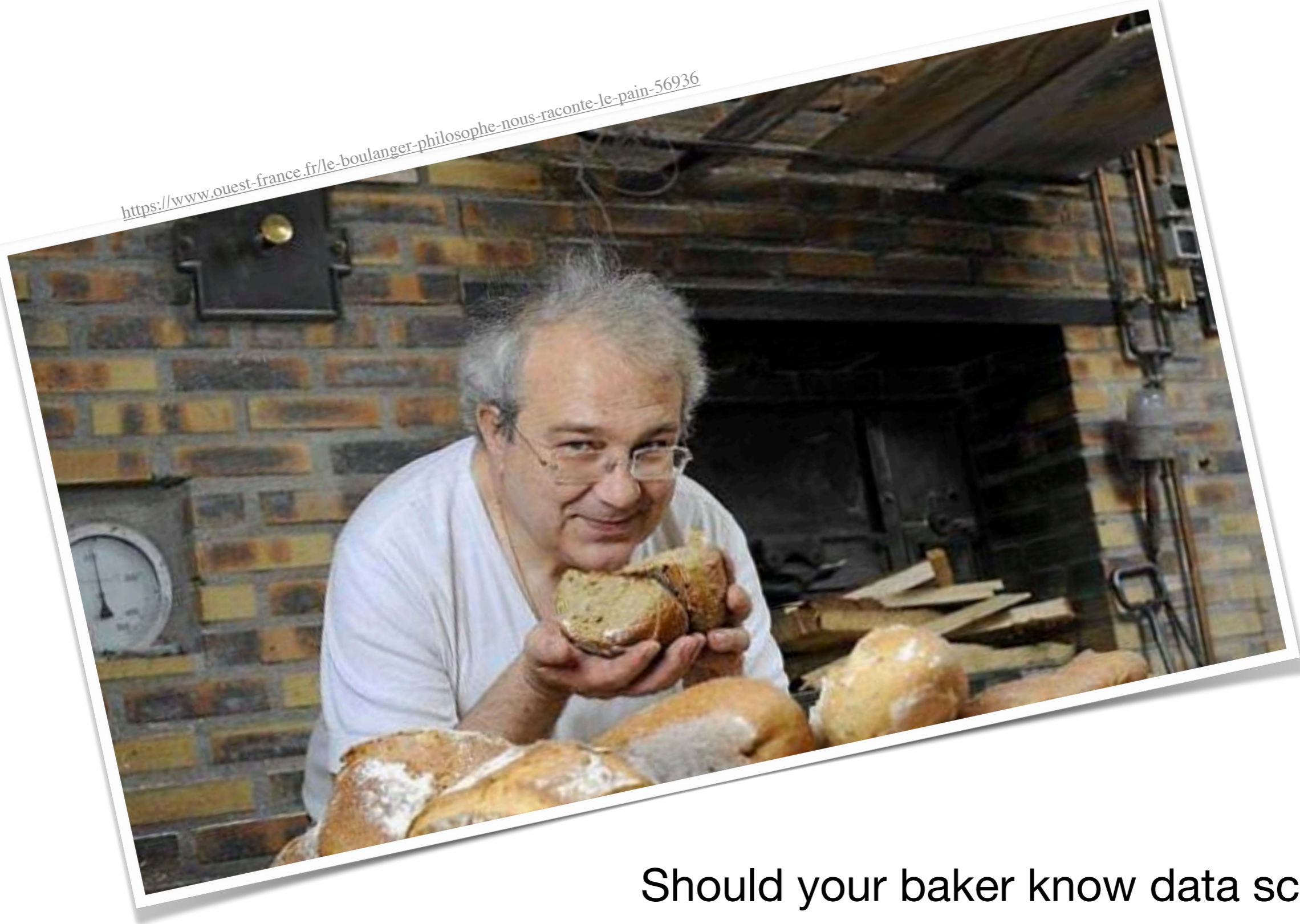

Should your baker know data sciences ?





# Panera Case Study in Big Data Analytics and Data Science



▶ ↺ 🔊 00:20 / 1:03:47









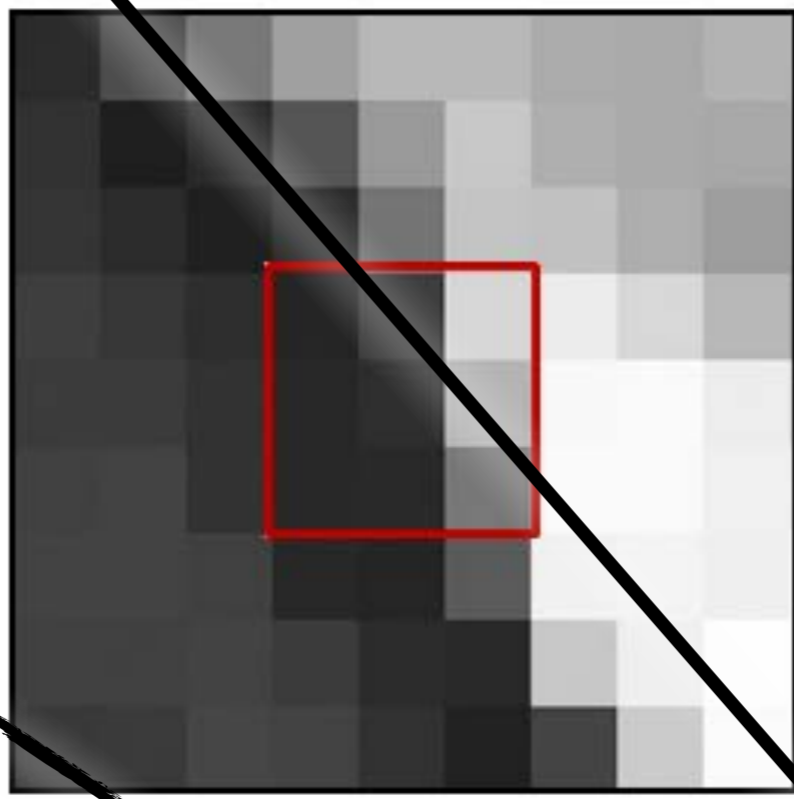
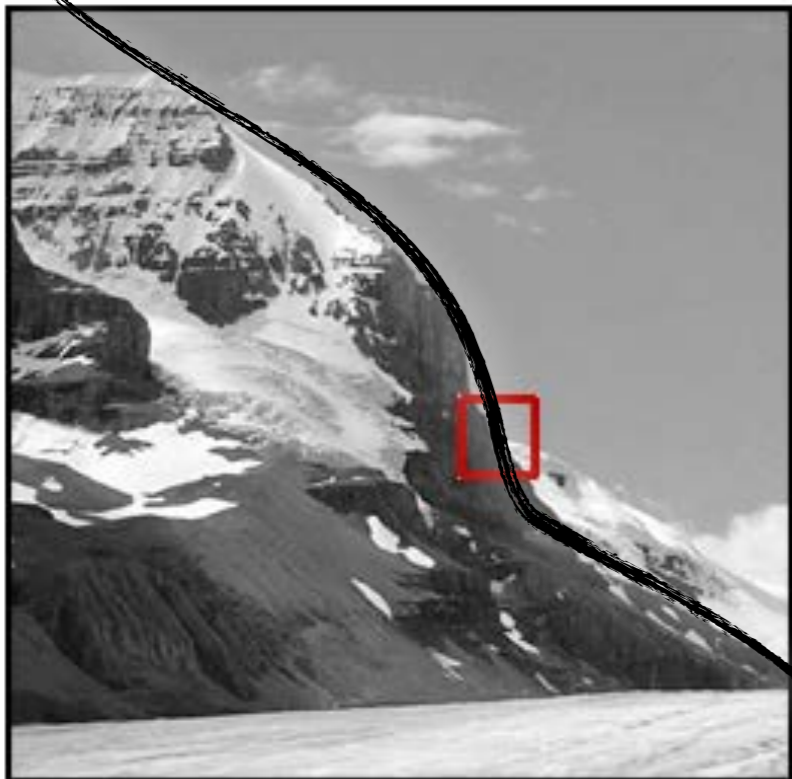

43	102	169
35	58	191
38	44	155

System Governance

3

Proportion of MOOC students who dropped out by # of logged online interactions with the website.

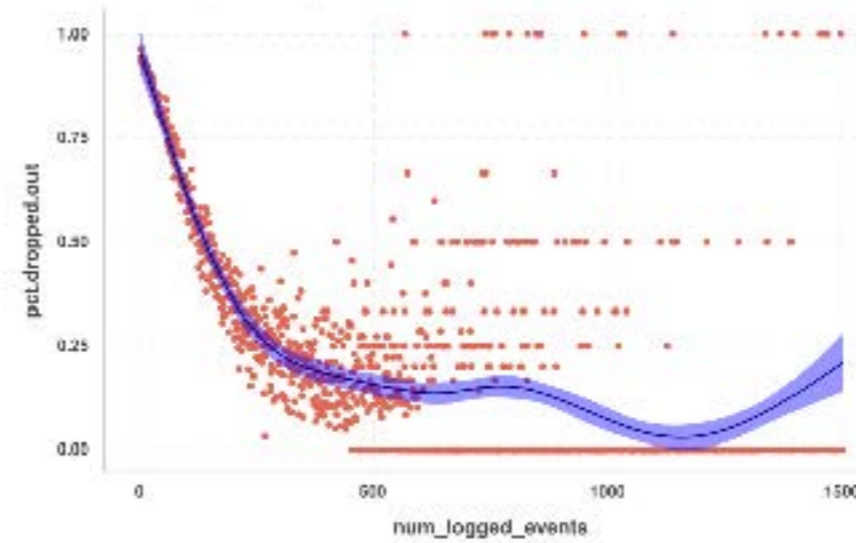

2 Pedagogical methods & tools



Digital technologies could enhance VET  
by **bridging** the school-workplace gap



capturing, enriching and expanding experience

« Der Erfahraum »



## Die Lernplattform für vernetzte Berufsbildung

REALTO wird von einem Team an der EPFL, der Universität Fribourg, und am EHB entwickelt. REALTO ist Teil des Forschungsprojekts Leading House DUAL-T welches durch das Schweizer Staatssekretariat für Bildung, Forschung und Innovation gefördert wird.

[HANDBUCH](#)[TUTORIALS](#)[FORSCHUNG](#)[LOGIN VERLANGEN](#)

 **Realto ist der erste Preisträger des Berufsbildungspreises der SGAB!**

[PRESSEMELDUNG \(DE\)](#)

« Der Erfahraum »



Guillaume Zufferey  
Lateral Studio Sàrl

15

Mein Fluss

Lerndokumentation

Hauptfluss

DEMO FLOW

Dual-T

Holzbau Schweiz

Sb2 - Prof. Terribilini

Test

ceff ARTISANAT - projet santé

Archivierte Flüsse

coloured blotch at the base of the tepals (petals), internally.



Flowers Tulips colors

Kommentar...

This is what I was working on today. Do you have anything similar?  
Mina S - 15.11.2017

Samuel V 10.11.2017 - Sb2 - Prof. Terribilini



Kommentar...

Activity feed header with RSS and group icons

- 21.11.2017  
Mina S. a effacé l'activité \*\*
- 15.11.2017  
Mina S. a démarré l'activité "Present your flower shop!"
- 15.11.2017 DEMO FLOW  
Mina Shirvani a modifié le délai de l'activité "Present your flower shop!"
- 02.11.2017  
Alessia C. a effacé l'activité "Cosa hai fatto oggi al lavoro?"
- 23.10.2017  
Alessia C. a démarré l'activité "ggg"
- 23.10.2017 DEMO FLOW  
Alessia Coppi (ADMIN) a modifié le délai de l'activité "ggg"
- 20.10.2017  
Alessia C. a démarré l'activité "-"
- 20.10.2017 DEMO FLOW  
Alessia Coppi (ADMIN) a modifié le délai de l'activité "undefined"
- 20.10.2017  
Alessia C. a démarré l'activité "Cosa hai fatto oggi al lavoro?"
- 20.10.2017 DEMO FLOW  
Alessia Coppi (ADMIN) a modifié le délai de l'activité "Cosa hai fatto oggi al lavoro?"
- 08.10.2017  
Mina S. a démarré l'activité "-"
- 06.10.2017  
Mina S. a effacé l'activité \*\*
- 06.10.2017  
Mina S. a effacé l'activité \*\*
- 04.10.2017  
Alessia C. a effacé l'activité \*\*
- 29.09.2017  
Alessia C. a effacé l'activité \*\*

<https://www.eduscenarios.ch/>



BRIDGING VET SCENARIOS

[Home](#)

[Loslegen](#)

[Erfahrungsraum-Modell](#)

[Szenarien](#)

[Werkzeuge](#)

[Book](#)



BRIDGING VET SCENARIOS

TECHNOLOGIES TO LINK SCHOOL AND WORKPLACE

Diese Website richtet sich an Lehrkräfte in der beruflichen Bildung, die auf der Suche nach schulischen Aktivitäten sind, die den Wissenstransfer von der Schule zum Arbeitsplatz und umgekehrt unterstützen.

[Erzählen Sie mir mehr](#)





Logistics assistants (warehouse employees)



KOSMOS 300  
KOSMOS 300  
KOSMOS 300  
KOSMOS 300  
KOSMOS 300  
KOSMOS 300

KOSMOS 300  
KOSMOS 300  
KOSMOS 300  
KOSMOS 300  
KOSMOS 300

KOSMOS 300  
KOSMOS 300  
KOSMOS 300  
KOSMOS 300

KOSMOS KÄFFER ART NR. 10011  
MADE IN CHINA  
KOSMOS KÄFFER ART NR. 10011  
MADE IN CHINA  
KOSMOS KÄFFER ART NR. 10011  
MADE IN CHINA  
KOSMOS KÄFFER ART NR. 10011  
MADE IN CHINA

KOSMOS KÄFFER-KUNTER  
ART NR. 10011  
MADE IN CHINA

KOSMOS  
DEHEMA-PEHIGOP  
ART NR. 10011  
INHALT: 5 STK.  
MADE IN CHINA

GO FORGET IT

Elektronik  
Kosmos



 Simpliquity

20 étages Gerbeur

surface brut de stockage:  $2400\text{m}^2$   
 degré d'utilisation (1): 83%  
 surface net de stockage:  $68\text{m}^2$   $23\text{ch} = 45\text{m}^2$  15 étage.

# Contre poids

13 étages

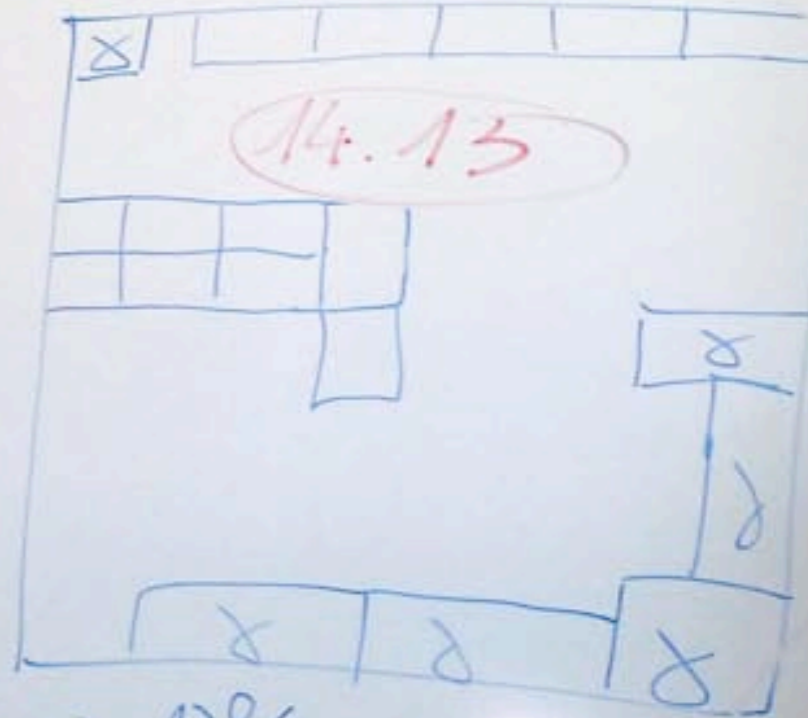
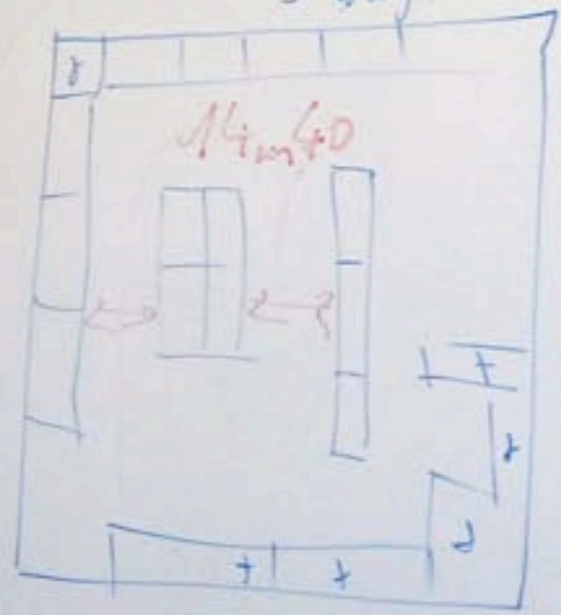
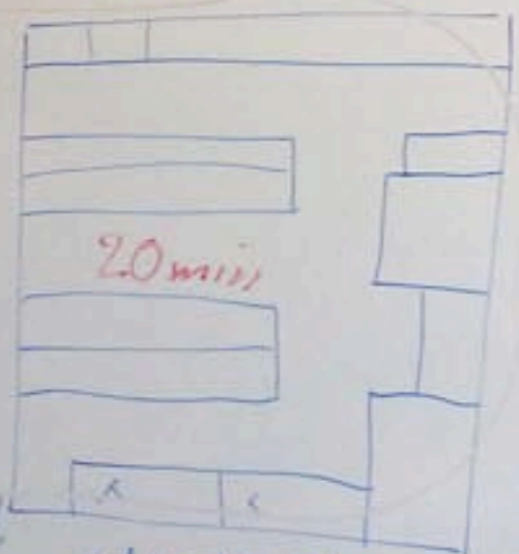

SB =  $288\text{m}^2$   
 SBST =  $244\text{m}^2$

Degré 2 = 17%  
 Degré 3 = 20%

surface net de stockage / brut = 23%

= 15%

net de stockage / brut de stockage = 28%

= 19%

= 13%

Degré d'utilisation 86%  
 SA =  $50\text{m}^2$



# Statics for Carpenters

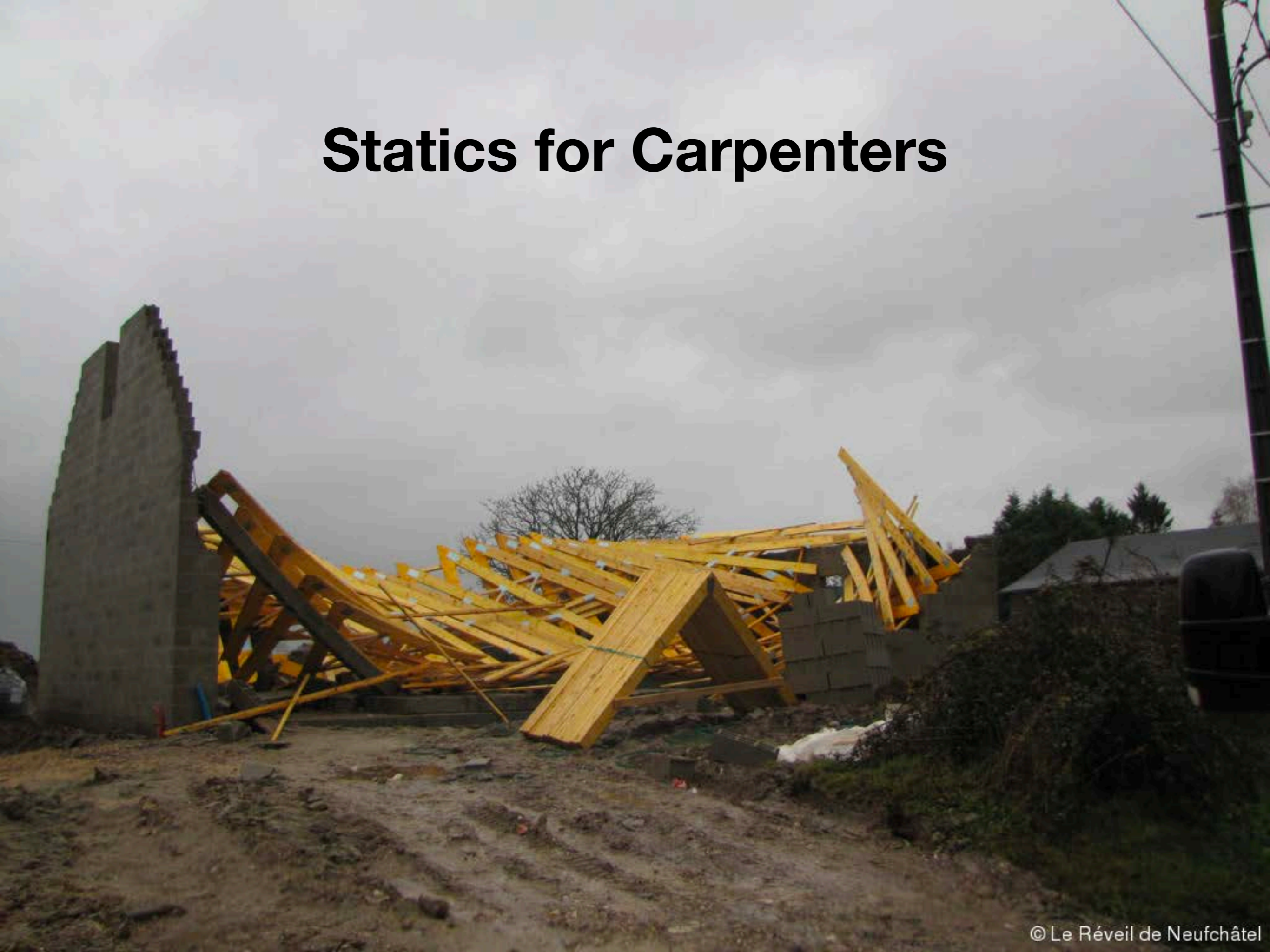

<https://www.mehariclub.com/retroiseur-exterieur-2cv-gauche-origine--a--2600902.html>



## Réalité Augmentée Erweiterte Realität

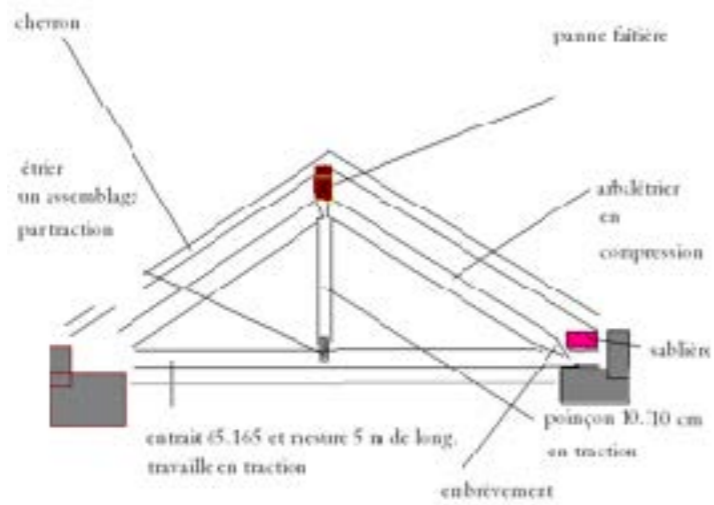

<http://evtod.com/>

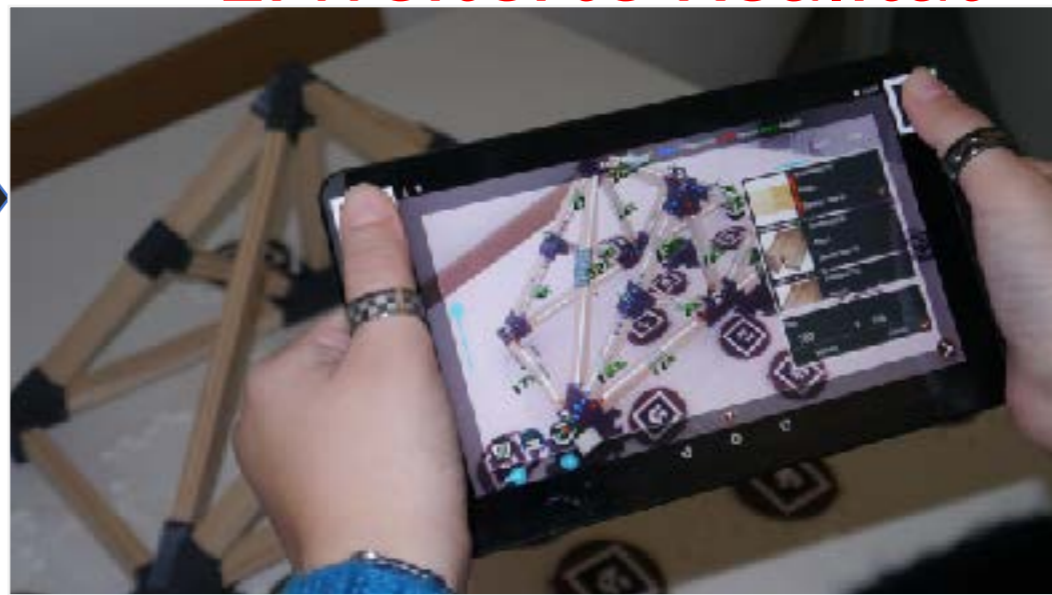

The value of augmented reality is how it **differs** from reality

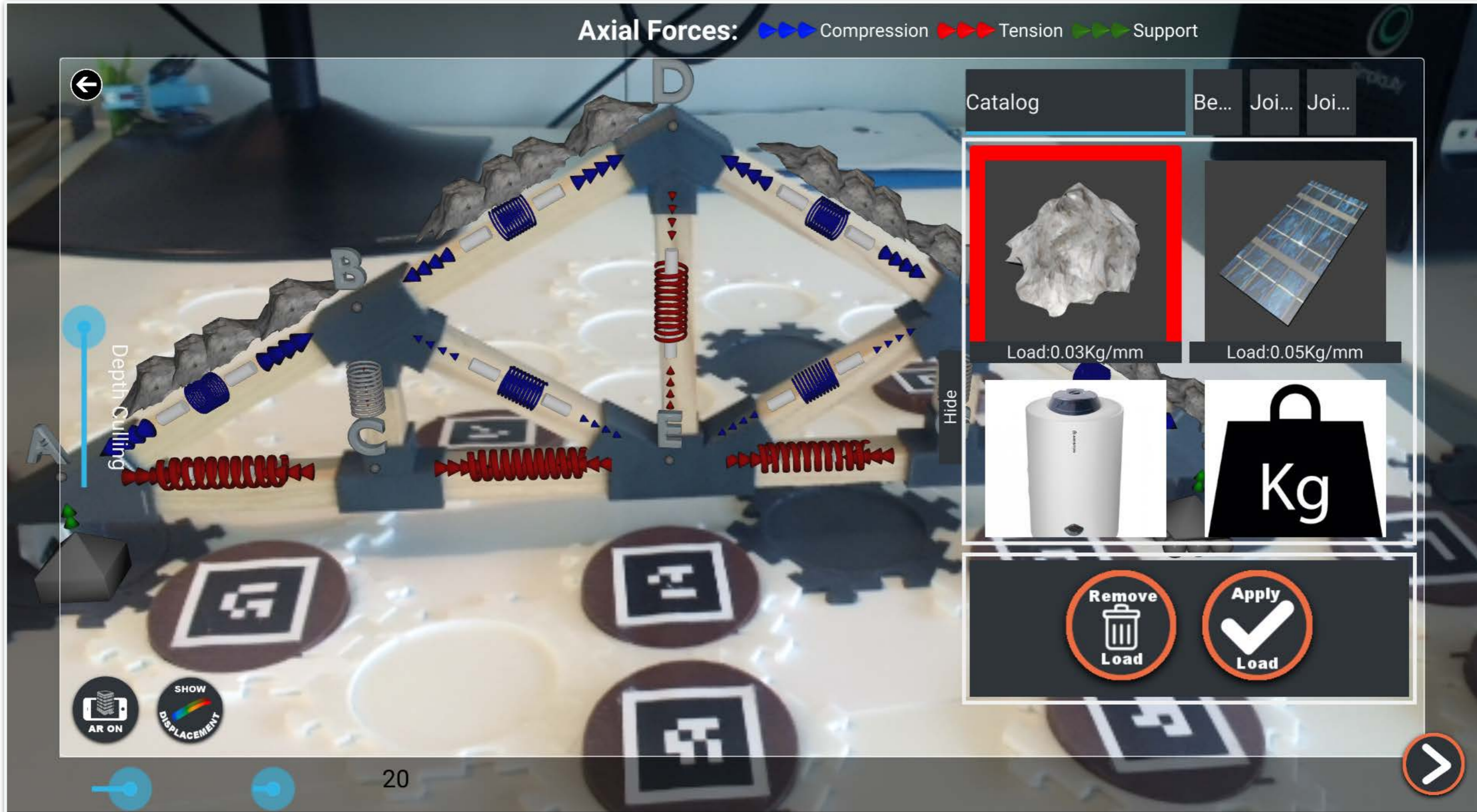

Make the invisible forces visible



In the real world,  
we do **not** move shelves with 2 fingers !



AVANT | APRÈS



The value of augmented reality is  
how it **differs** from reality

System Governance

3

Proportion of MOOC students who dropped out by # of logged online interactions with the website.

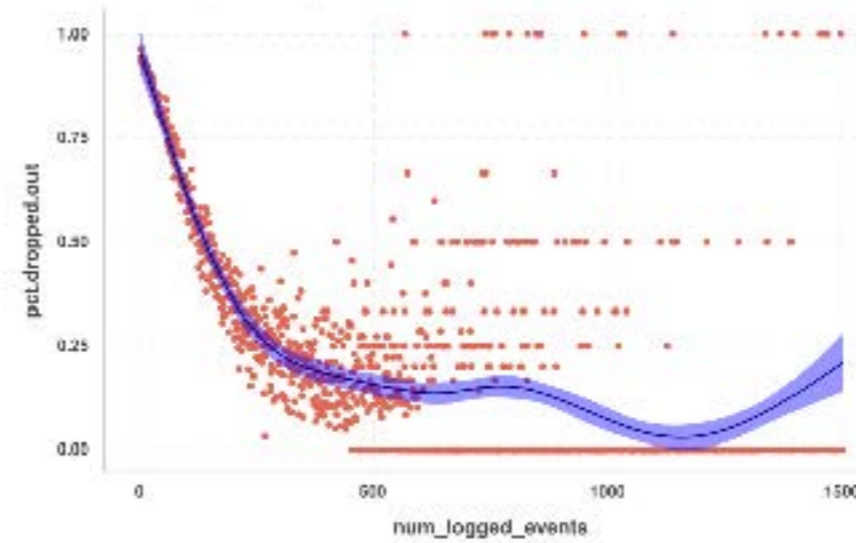

2 Pedagogical methods  
& tools

Goals &  
Contents





Pierre Billenbourg - Alberta Cottanero - Jean-Luc Gartner - Richard Lee Davis  
Editeurs

## Educational Technologies for Vocational Training

Experiences as Digital Clay

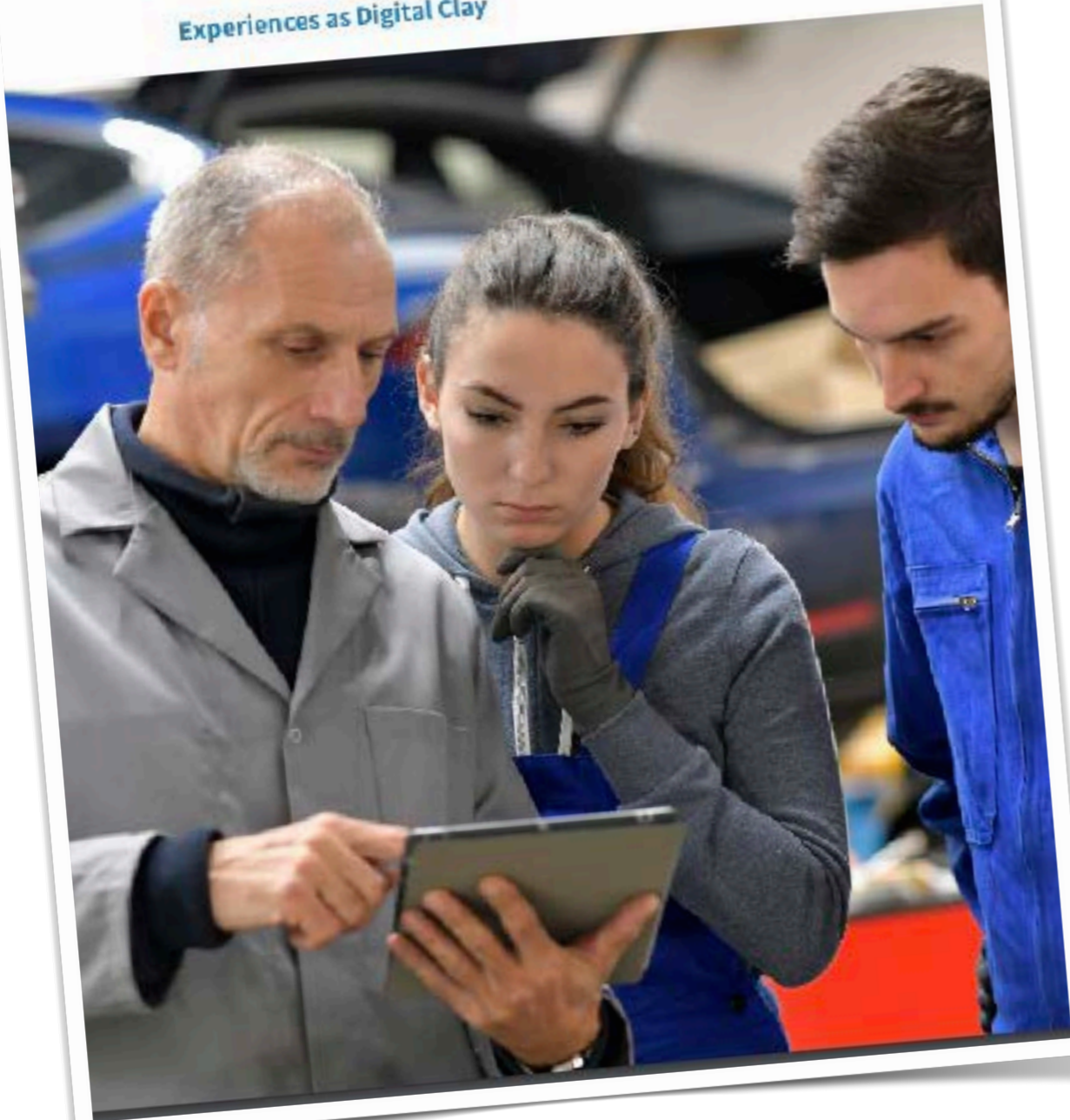

EPFL

### Available online (free)

Can be printed on-demand in Amazon  
In a few days also in FR, DE and IT !

### New chair in VET & learning analytics Prof. Tanja Käser

#### International collaborations

- India
- Singapore
- Moocs4Africa
- Excellence in Africa
- JF: Ivory Coast, Ghana, Columbia
- Madagascar

EPFL